

TRADE – RETAIL 2025



PRICE LIST 2025

TRADE – RETAIL

Update January 2025



OUR PRODUCTS

Linea	6
Polestar Touch	12
Polestar Touch self-service automatic adhesive cutter	14
Platform control units	16
Sun Eco Color	17
Sun Eco Color Volo	18

COMMERCIAL PLASTIC SCALES

Alex Color	26
Alex Color Extra	28
Alex Color "Special Edition"	29
Alex Color Bassa	30
Alex Color Extra Bassa	31
Alex	32
Alex with labeller ZD421T	34

PC-TOUCH labelling stations	40
Pc Touch Screen	41
Labelling software Labelone	42

WEIGHT-ONLY SCALES

GTW-INOX Scale	47
Cometa Scale	48
ACS-Z Scale	49

Sun Eco Plus Alta	19
Sun Eco Plus Bassa	20
Sun Eco Plus Volo	21
Sun Eco	22
Sun Eco Bassa	23
Sun Eco Volo	24

SCALES COMMERCIAL STAINLESS STEEL

Alex Bassa	35
Alex Mare	36
Alex Mare Bassa	37
Stella	38
Mini Stella	39

Trolleys	43
Label printers	44
Barcode readers	45
Weight-pricing machine	46

WEIGHING AND LABELLING STATIONS

Floor scale Mercury 24 Italy	50
Calybra	51
Calybra Bakery	52



LINEA

Technical characteristics:

- 3-inch thermal label printer with label dispenser, 8 dots/mm, 150 mm/sec max
- Paper width: 60mm - 80mm (max. external diameter 100mm),
- Printing on thermal label roll, continuous adhesive label roll, adhesive labels
- Operator and customer-facing screen: 15.6" Full HD resolution (1920x1080)
- Touch screen (operator screen): capacitive, anti-fingerprint treatment, suitable for use with wet fingers and latex gloves
- 1 x USB 3.0, 3 x USB 2.0, 1 x RS232C, 2 x Ethernet TCP/IP (1+1 with passthrough)
- Networking: up to 25 scales
- Wi-Fi and Bluetooth (optional)
- PC, cash register and barcode reader interface
- POS interface (optional)
- Power supply: 100-240 VAC
- External battery feed: 24 VDC +/-10%.
- Dimensions: 360mm (base width), 470mm (depth), 654mm (height)
- Available weights: 12/30kg-2/5g (standard); 30kg-5g; 12kg-2g; 6kg-1g



Functional Features:

- Storable PLUs: unlimited
- Receipt header: 7 lines (max. 200 characters/line)
- Article description (management): max 255 characters
- Management of PLU groups and departments according to user-settable criteria
- Automatic tare, manual tare, tare associated with PLU, programmable tare, cumulative tare with interactive management in the metrology section
- Programmable tares: 16
- Configurable VAT rates with automatic allocation
- Departments with associated VAT and user-configurable icon
- Management of users and access permissions (passwords) to the various functionalities
- Operators: 16
- Configurable operator keys with name, colour and status indication
- Configurable operator interface and customer-facing screen layouts
- On-screen position of numeric pad and metric section configurable
- Ingredient and recipe management
- Product traceability tracking
- Management of nutritional value tables for products
- Management of EAN-13, EAN-128 and QR Code barcodes
- Display in Full HD resolution (1920x1080) and customer-side display images
- Image import from web, cloud, USB with automatic format optimisation and cropping function
- Management of date of packing, expiry date and batch
- Print general totals, by operator, by article, by PLU group
- Graphic logo printing
- Printing modes: label, single receipt and consolidated receipt
- Customizing the label layout
- Filterable log of totals and transactions with reprint option
- Quick price change button with adjustable permissions (password)
- Return, discount, reopening of receipt by operator, reversal of receipt by operator
- Customisable keys
- Queue control function
- Generation of a receipt at the till with QR Code
- Advanced cloud features accessible online (management, upgrade, support, backup, app-store, etc.).
- Scales can operate offline (locally) or online (cloud-connected)
- On-screen receipt preview
- Intuitive, customisable graphical interface, ergonomic menus
- Management functionality (configuration, queries, etc.) via smartphone/tablet
- Interactive metrology section
- Fully interactive operator screen
- Help and online documentation

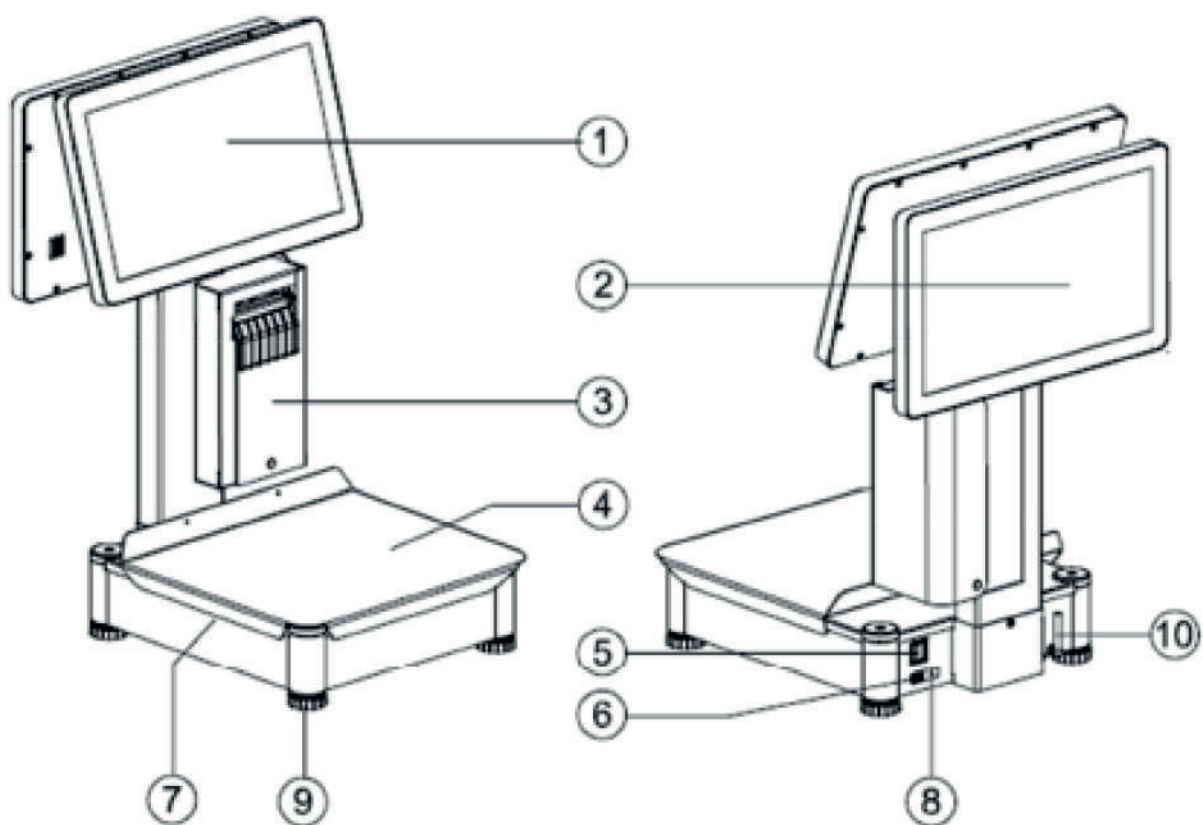

- 1. Operator screen
- 2. Customer-facing screen
- 3. Paper compartment door
- 4. Scale pan
- 5. ON/OFF button
- 6. USB 2.0 port
- 7. Level bubble (under the pan)
- 8. Power LED
- 9. Levelling feet
- 10. Wi-Fi antennas (option)
- 11. Connector panel
- 12. Adapter cable lock

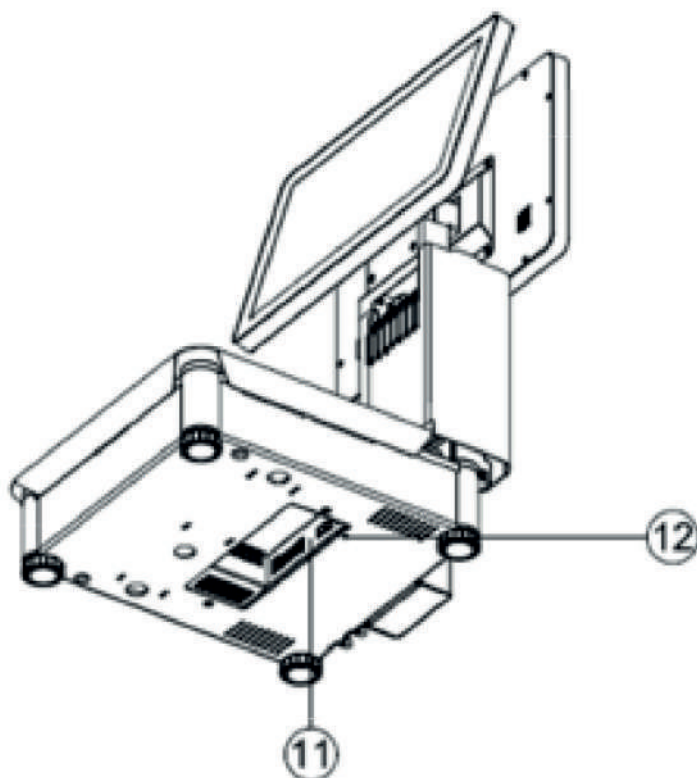





Model	Code
LINEA	NLNA030-N3

Accessories and options	Code
Bowl pan	OSU0PTB
Ethernet cable 1.5 m	ACV-PATCH
Ethernet Cable 5 m	ACV-PATCH-5
Ethernet Network Switch	OSM-SWITCH
24 Volt output (truck cable)	OPST-24V
Thermal label roll 2'' (outer diameter max. 100) inner core hole 25mm	
Thermal label roll 3'' (outer diameter max. 100) inner core hole 25mm	
Adhesive thermal label roll 2'' (outer diameter max. 100) inner core hole 25mm	
Scale cover	ACOPRIBILANCIA



POLESTAR TOUCH



Stainless steel version

Painted steel version: red, white and black

Technical specifications:

- Capacity 12/30 kg division 2/5 g multirange
- Up to 16 operators
- Networking of up to 16 scales
- 9.999 PLUs
- Thermal printer with automatic cutter
- Equipped with 2 colour LCD displays, operator-side display 12" with resistive touch and 12" customer-side display
- Versions available with 2" or 3" printers
- Outputs: 4xUSB, 1xEthernet, 1xRs232
- Internal disk memory: 8 Gb
- RAM memory: 2 Gb
- External 24 V power supply
- Internal battery included
- Linerless adhesive paper printer kit (optionally available for 2" and 3" printer version)

Software:

- Android-based operating system
- Intuitive graphical user interface menus to simplify and speed up work
- Possibility to insert graphic logos
- Possibility of inserting product images to match the touch screen buttons
- Possibility of running advertising videos on the customer-side display

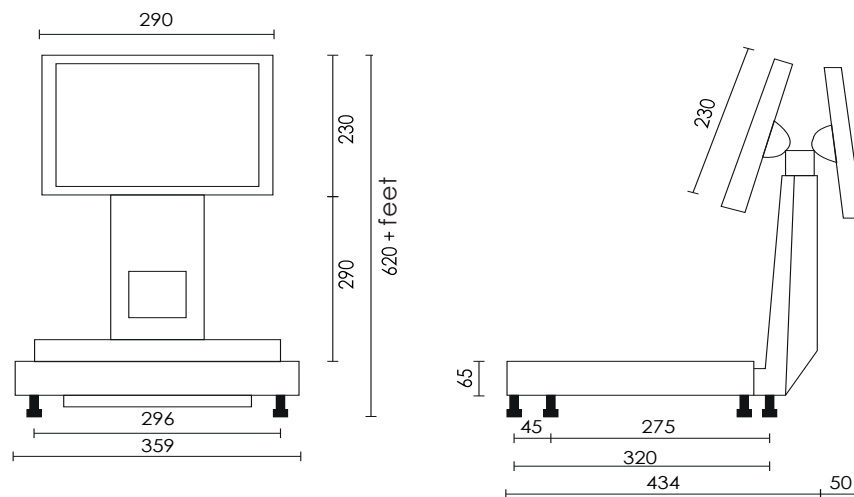

Model

POLESTAR stainless steel with 2" printer

White POLESTAR with 2" printer

Black POLESTAR with 2" printer

Red POLESTAR with 2" printer

Code

NPST030-N2

NPST030-N2-W

NPST030-N2-B

NPST030-N2-R



Operator side

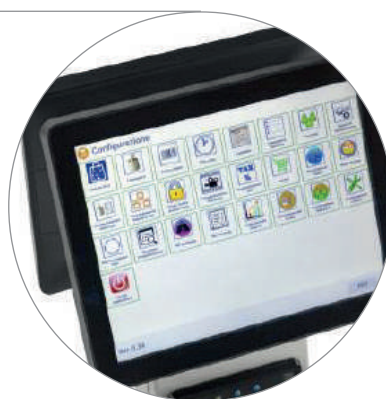

The front feet can be mounted in the first hole or in the second (depending on the depth of the bench of support)



Accessories and options

Basin plate

Stainless steel foot each

Ethernet cable 1.5 m

Ethernet cable 5 m

Ethernet network switch

24 Volt Output

Linerless adhesive paper printer kit for 2" version with automatic cutter

Linerless adhesive paper printer kit for 3" version with automatic cutter

Configuration software for POLESTAR

Thermal neutral roll 57x60 each

Thermal neutral roll 80x78 each

Permanent adhesive linerless roll mm 58x28 mt each

Scale cover

Code

OSU0PTB

APV10449IM10X25

ACV-PATCH

ACV-PATCH-5

OSM-SWITCH

OPST-24V

OPST-LYN-2

OPST-LYN-3

WCONF-PST

CRCT-57X60

CRCT-80X80

CRAZ-57X61X28

ACOPRIBILANCIA



RETAIL

POLESTAR TOUCH

SELF-SERVICE VERSION WITH AUTOMATIC ADHESIVE CUTTER



Technical specifications:

- Capacity 12/30 kg division 2/5 g multirange
- Up to 16 operators
- Networking of up to 16 scales
- 9.999 PLUs
- Thermal printer with automatic cutter
- Versions available with 2" or 3" printers
- Outputs: 4xUSB, 1xEthernet, 1xRs232
- Internal disk memory: 8 Gb, RAM memory: 2 Gb
- External 24 V power supply (internal battery included)
- Internal battery included
- Equipped with 2 colour LCD displays, 12" operator-side display with resistive touch and 12" customer-side display
- Linerless adhesive paper printer kit (optionally available for 2" and 3" printer version)

Software:

- Android-based operating system
- Intuitive graphical user interface menus to simplify and speed up work
- Possibility of inserting graphic logos
- Possibility to insert product images to match the touch screen buttons
- Possibility of running advertising videos on the customer-side display



Model	Code
POLESTAR ADHESIVE stainless steel with 2" printer	NPST030-A2
White POLESTAR ADHESIVE with 2" printer	NPST030-A2-W
Black POLESTAR ADHESIVE with 2" printer	NPST030-A2-B
Red POLESTAR ADHESIVE with 2" printer	NPST030-A2-R

Accessories and options	Code
Basin plate	OSU0PTB
Stainless steel foot each	APV10449IM10X25
Ethernet cable 1.5 m	ACV-PATCH
Ethernet cable 5 m	ACV-PATCH-5
Ethernet network switch	OSM-SWITCH
24 Volt Output	OPST-24V
Configuration software for POLESTAR	WCONF-PST
Permanent adhesive linerless roll 58x28 mt each	CRAZ-57X61X28
Scale cover	ACOPRIBILANCIA

Control unit TW/SUN ECO V.G.A.



Sun Eco Plus



Alex

Technical specifications:

- Stainless steel body with anodised aluminium column
- Local networking, RS-232/485, connection with PC, modem and connection to cash register
- External 12/24 Volt power supply option
- Radio frequency network option
- Ethernet card option
- Software loading programme for scale
- Internal rechargeable batteries

Model

Control Unit SunPlus

Control Unit SunAlex

Code

NCVS-N8

NCVA-N8

Accessories and options

Ethernet card

Networking cable (if needed)

Factory-fitted 12/24 volt output

Factory-fitted radio frequency kit

Transparent key cover

Double deck trolley M40 for control unit painted

Double deck trolley M40 for stainless steel control

Double deck trolley M60 for control unit painted

Double deck trolley M60 for stainless steel control unit

Top quality adhesive paper kit

Confbil configuration software

Code

ASE5076-ETH

ACVTEL-4X0.12

ASE9008.0.AMBUL

OSU0RFQ

ACOPRITASTI

OM40C2PC

OM41C2PC

OM60C2PC

OM61C2PC

AASKEDP

WCONF-ECO

SUN ECO COLOR



Technical specifications:

- Stainless steel frame
- 7" colour display
- Washable touchless high-speed or mechanical keyboard
- 8 dots/mm thermal printer with "easy loading" device
- Linerless adhesive paper option
- Print speed 70 mm/s
- Paper width 57 mm
- Programmable receipt header (5 lines of 26 characters)
- Automatic date and time management
- Single or cumulative receipt
- Printing of packing date and expiry date
- Print ingredient list associated with the PLU (12 lines of 45 micro characters)
- Batch insertion and printing
- EAN13 barcode printing
- 999 programmable PLUs - Change function
- Quick change of prices
- Re-opening receipt function
- Reverse entry function
- Semi-automatic, manual, pre-stored and associated tare
- Partial total of 8 operators on screen
- Up to 6 scales in LAN network (wired or RF)
- Scale programming from PC
- General, PLU and operator totals
- Optional radio frequency kit
- 4-8-16 operators
- Optional 12/24V external power supply
- Internal rechargeable battery
- Customer-side graphic images
- Available capacities: 30kg/5g; 12-30kg/2-5g 12kg/2g; 6kg/1g

Model	Code
SUN ECO COLOR mechanical keyboard	NSUE030-CM8
SUN ECO COLOR capacitive keyboard	NSUE030-CC8
Accessories and options	Code
Basin plate	OSU0PTB
Networking cable	ACVTEL-4X0.12
Factory-fitted 12/24V output	ASE9001.0.AMBUL
Factory-fitted radio frequency kit	OSU0RFQ
Stainless steel foot each	APV10449IM10X25
Top quality adhesive paper printer kit factory fitted	AASKEDP
Transparent key cover cap	ACOPRITASTI
Thermal neutral roll 57x30 each	CRCT-57B
Adhesive linerless 55.5x18 each	CRAZ-57X50 X18
Confbil configuration software	WCONF-ECO
Scale cover	ACOPRIBILANCIA
Ethernet card	ASE5076-ETH



SUN ECO COLOR VOLO

Technical specifications:

- Stainless steel frame
- 7" colour display
- Washable touchless high-speed or mechanical keyboard
- 8 dots/mm thermal printer with "easy loading" device
- Linerless adhesive paper option
- Print speed 70 mm/s
- Paper width 57 mm
- Programmable receipt header (5 lines of 26 characters)
- Automatic date and time management
- Single or cumulative receipt
- Print packing date and expiry date
- Print ingredient list associated with the PLU (12 lines of 45 micro characters)
- Batch insertion and printing
- Print EAN13 barcode
- 999 programmable PLUs
- Change function
- Quick change of prices
- Re-opening receipt function
- Reverse entry function
- Semi-automatic, manual, pre-stored and associated tare
- Partial total of 8 operators on screen
- Up to 6 scales in LAN network (wired or RF)
- Scale programming from PC
- General, PLU and operator totals
- Optional radio frequency kit
- 4-8-16 operators
- Optional 12/24V external power supply
- Internal rechargeable battery
- Customer-side graphic images
- Available capacities: 30kg/5g; 12-30kg/2-5g; 12kg/2g; 6kg/1g

Model

SUN ECO COLOR VOLO tastiera meccanica
SUN ECO COLOR VOLO tastiera capacitiva

Code

NSUV030-CM8
NSUV030-CC8

Accessories and options

Networking cable
Factory-fitted 12/24V output
Factory-fitted radio frequency kit
Top quality adhesive paper printer kit factory fitted
Ethernet card
Support plate
T-joint
Steel tube Ø 35 per metre
Thermal neutral roll 57x30 each
Adhesive linerless 55.5x18 each
Confbil configuration software

Code

ACVTEL-4X0.12
ASE9001.0.AMBUL
OSU0RFQ
AASKEDP
ASE5076-ETH
OST0PS
OST0GT
OST0TA
CRCT-57B
CRAZ-57X50X18
WCONF-ECO

SUN ECO PLUS ALTA

Technical specifications:

- Stainless steel construction
- Custom backlit LCD display
- High-speed washable touchless keyboard
- 8 dots/mm thermal printer with "easy loading" device
- Linerless adhesive paper option
- Print speed 70 mm/s
- Paper width 57mm
- Programmable receipt header (5 lines of 26 characters)
- Automatic date and time management
- Single or cumulative receipt
- Print date and expiry date
- Print list of ingredients associated with the PLU (6 lines of 45 micro characters)
- Batch insertion and printing
- EAN13 barcode printing
- 999 programmable PLUs - Quick price change
- Change function
- Re-opening receipt function
- Reverse entry function
- Semi-automatic, manual, pre-stored and associated tare
- Partial total of 4 operators on screen
- Up to 6 scales in LAN network (wired or RF)
- Scale programming from PC
- General, PLU and operator totals
- Optional radio frequency kit
- 4-8-16 operators
- External 12/24V power supply
- Internal battery autonomy of about 35/40 hours
- Customer-side advertising
- Available capacities: 30kg/5g; 12-30kg/2-5g; 12kg/2g; 6kg/1g



Model	Code
SUN ECO PLUS ALTA KG.12/30 MULTIRANGE 4/8/16 operators	NSUS030-N8

Accessoires et options	Code
Basin plate	OSU0PTB
Networking cable	ACVTEL-4X0.12
Factory fitted 12/24V output	ASE9001.0.AMBUL
Factory-fitted radio frequency kit	OSU0RFQ
Stainless steel foot each	APV10449IM10X25
Top quality adhesive paper printer kit factory fitted	AASKEDP
Thermal neutral roll 57x30 each	CRCT-57B
Adhesive linerless 55.5x18 each	CRAZ-57X50X18
Confibil configuration software	WCONF-ECO
Scale cover	ACOPRIBILANCIA
Ethernet card	ASE5076-ETH

SUN ECO PLUS BASSA



Technical specifications:

- Stainless steel frame
- Custom backlit LCD display
- High-speed washable touchless keyboard
- 8 dots/mm thermal printer with "easy loading" feature
- Linerless adhesive paper option
- Print speed 70 mm/s
- Paper width 57mm
- Programmable receipt header (5 lines of 26 characters)
- Automatic date and time management
- Single or cumulative receipt
- Printing of packing date and expiry date
- Print list of ingredients associated with the PLU (6 lines of 45 micro characters)
- Batch insertion and printing
- EAN13 barcode printing
- Change Function
- Re-opening receipt function
- Reverse entry function
- Semi-automatic, manual, pre-stored and associated tare
- Partial total of 4 operators on screen
- Up to 6 scales in LAN network (wired or RF)
- Scale Programming from PC
- General, PLU and operator totals
- Optional radio frequency kit
- 4-8-16 operators
- Optional 12/24V external power supply
- Internal battery autonomy of about 35/40 hours
- Customer-side advertising
- Available capacities: 30kg/5g; 12-30kg/2-5g; 12kg/2g; 6kg/1g

Model

SUN ECO PLUS BASSA KG.12/30 MULTIRANGE 4/8/16 operators

Code

NSUS030-N8/B

Accessories and options

Accessories and options	Code
Basin plate	OSU0PTB
Networking cable	ACVTEL-4X0.12
Factory fitted 12/24V output	ASE9001.0.AMBUL
Factory-fitted radio frequency kit	OSU0RFQ
Stainless steel foot each	APV10449IM10X25
Top quality adhesive paper printer kit	AASKEDP
Thermal neutral roll 57x30 each	CRCT-57B
Adhesive linerless 55.5x18 each	CRAZ-57X50X18
Confbil configuration software	WCONF-ECO
Ethernet card	ASE5076-ETH

SUN ECO PLUS VOLO

Technical specifications:

- Stainless steel frame
- Custom backlit LCD display
- High-speed washable touchless keyboard
- 8 dots/mm thermal printer with "easy loading" device
- Linerless adhesive paper option
- Print speed 70 mm/s
- Paper width 57mm
- Programmable receipt header (5 lines of 26 characters)
- Automatic date and time management
- Single or cumulative receipt
- Print date and expiry date
- Print list of ingredients associated with the PLU (6 lines of 45 micro characters)
- Batch insertion and printing
- EAN13 barcode printing
- 999 programmable PLUs - Quick price change
- Change function
- Re-open receipt function
- Reverse entry function
- Semi-automatic, manual, pre-stored and associated tare
- Partial total of 4 operators on screen
- Up to 6 scales in LAN network (wired or RF)
- Scale programming from PC
- General, PLU and operator totals
- Optional radio frequency kit
- 4-8-16 operators
- Optional 12/24V external power supply
- Internal rechargeable battery
- Customer-side advertising
- Available capacities: 30kg/5g; 12-30kg/2-5g; 12kg/2g; 6kg/1g



Accessori

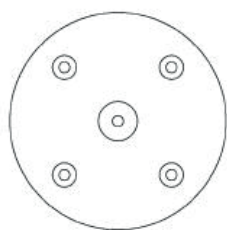

Support plate

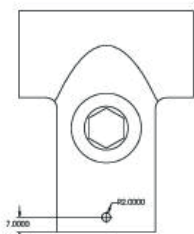

T-joint

Model	Code
SUN ECO PLUS VOLO KG.12/30 MULTIRANGE 4/8/16 operators	NSUS030-N8/V
Options	Code
Networking cable	ACVTEL-4X0.12
Factory fitted 12/24V output	ASE9001.0.AMBUL
Factory-fitted radio frequency kit	OSU0RFQ
Top quality adhesive paper printer kit factory fitted	AASKEDP
Ethernet card	ASE5076-ETH
Accessories	Code
Support plate	OST0PS
T-joint	OST0GT
Steel pipe Ø 35 per metre	OST0TA
Thermal neutral roll 57x30 each	CRCT-57B
Adhesive linerless 55.5x18 each	CRAZ-57X50X18
Confbil configuration software	WCONF-ECO



SUN ECO

Technical specifications:

- Stainless steel construction
- Custom LCD backlit display
- Mechanical keyboard with rubber keys
- 8 dots/mm thermal printer with "easy loading" device
- Linerless adhesive paper option
- 70mm/s print speed
- 57mm paper width
- Programmable receipt header (5 lines of 26 characters)
- Automatic date and time management
- Single or cumulative receipt
- Printing of packing date and expiry date
- Printing of ingredient list associated to the PLU (6 lines of 45micro characters)
- Batch insertion and printing
- EAN13 barcode printing
- 999 programmable PLUs
- Quick price change
- Change function
- Re-opening receipt function
- Reverse entry function
- Semi-automatic, manual, pre-stored and associated tare
- Partial total of 4 operators on screen
- Up to 6 scales in LAN network (wired or RF)
- Scale programming from PC
- General, PLU and operator totals
- Optional radio frequency kit
- 4-8-16 operators
- Optional 12/24V external power supply
- Internal battery with autonomy of about 35/40 hours
- Customer-side advertising
- Available capacities: 30kg/5g; 12-30kg/2-5g; 12kg/2g; 6kg/1g



Model	Code
SUN ECO KG.12/30 MULTIRANGE 4/8/16 operators	NSUE030-N8
Accessories and options	Code
Basin plate	OSU0PTB
Networking cable	ACVTEL-4X0.12
Factory fitted 12/24V output	ASE9001.0.AMBUL
Factory-fitted radio frequency kit	OSU0RFQ
Stainless steel foot each	APV10449IM10X25
Top quality adhesive paper printer kit factory fitted	AASKEDP
Transparent key cap	ACOPRITASTI
Thermal neutral roll 57x30 each	CRCT-57B
Adhesive linerless 55.5x18 each	CRAZ-57X50X18
Confbil configuration software	WCONF-ECO
Scale cover	ACOPRIBILANCIA
Ethernet card	ASE5076-ETH

SUN ECO BASSA



Technical specifications:

- Stainless steel construction
- Custom LCD backlit display
- Mechanical keyboard with rubber keys
- 8 dots/mm thermal printer with "easy loading" device
- Linerless adhesive paper option
- 70mm/s print speed
- 57mm paper width
- Programmable receipt header (5 lines of 26 characters)
- Automatic date and time management
- Single or cumulative receipt
- Printing of packing date and expiry date
- Printing of ingredient list associated to the PLU (6 lines of 45micro characters)
- Batch insertion and printing
- EAN13 barcode printing
- 999 programmable PLUs
- Fast price change
- Change function
- Reopening receipt function
- Reverse entry function
- Semi-automatic, manual, pre-stored and associated tare
- Partial total of 4 operators on screen
- Up to 6 scales in LAN network (wired or RF)
- Scale Programming from PC
- General, PLU and operator totals
- Optional radio frequency kit
- 4-8-16 operators
- Optional 12/24V external power supply
- Internal battery with autonomy of about 35/40 hours
- Customer-side advertising
- Available capacities: 30kg/5g; 12-30kg/2-5g; 12kg/2g; 6kg/1g

Model	Code
SUN ECO KG.12/30 MULTIRANGE 4/8/16 operators	NSUB030-N8
Accessories and options	Code
Basin plate	OSU0PTB
Networking cable	ACVTEL-4X0.12
Factory fitted 12/24V output	ASE9001.0.AMBUL
Factory-fitted radio frequency kit	OSU0RFQ
Stainless steel foot each	APV10449IM10X25
Top quality adhesive paper printer kit factory	AASKEDP
Transparent key cap	ACOPRITASTI
Thermal neutral roll 57x30 each	CRCT-57B
Adhesive linerless 55.5x18 each	CRAZ-57X50X18
Confbil configuration software	WCONF-ECO
Ethernet card	ASE5076-ETH



SUN ECO VOLO



Technical specifications:

- Stainless steel frame
- Custom backlit LCD display
- Mechanical keyboard with rubber keys
- 8 dots/mm thermal printer with "easy loading" device
- Linerless adhesive paper option
- Print speed 70 mm/s
- Paper width 57mm
- Programmable receipt header (5 lines of 26 characters)
- Automatic date and time management
- Single or cumulative receipt
- Print date and expiry date
- Print list of ingredients associated with the PLU (6 lines of 45 micro characters)
- Batch insertion and printing
- EAN13 barcode printing
- 999 programmable PLUs
- Quick change of prices
- Change function
- Reopen receipt function
- Reverse entry function
- Semi-automatic, manual, pre-stored and associated tare
- Partial total of 4 operators on screen
- Up to 6 scales in LAN network (wired or RF)
- Scale programming from PC
- General, PLU and operator totals
- Optional radio frequency kit
- 4-8-16 operators
- Optional 12/24V external power supply
- Internal rechargeable battery
- Customer-side advertising
- Available capacities: 30kg/5g; 12-30kg/2-5g; 12kg/2g; 6kg/1g

Accessories

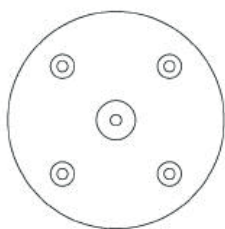

Support plate

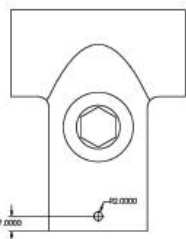

T-joint

Model	Code
SUN ECO VOLO KG.12/30 MULTIRANGE 4/8/16 operators	NSUV030-N8
Options	Code
Networking cable	ACVTEL-4X0.12
Factory-fitted 12/24V output	ASE9001.0.AMBUL
Factory-fitted radio frequency kit	OSU0RFQ
Top quality adhesive paper printer kit factory fitted	AASKEDP
Transparent key cover	ACOPRITASTI
Ethernet card	ASE5076-ETH
Accessories	Code
Support plate	OST0PS
T-Joint	OST0GT
Steel pipe Ø 35 per metre	OST0TA
Thermal neutral roll 57x30 each	CRCT-57B
Adhesive linerless 55.5x18 each	CRAZ-57X50X18
Confbil configuration software	WCONF-ECO

Hanging scale support parts using example

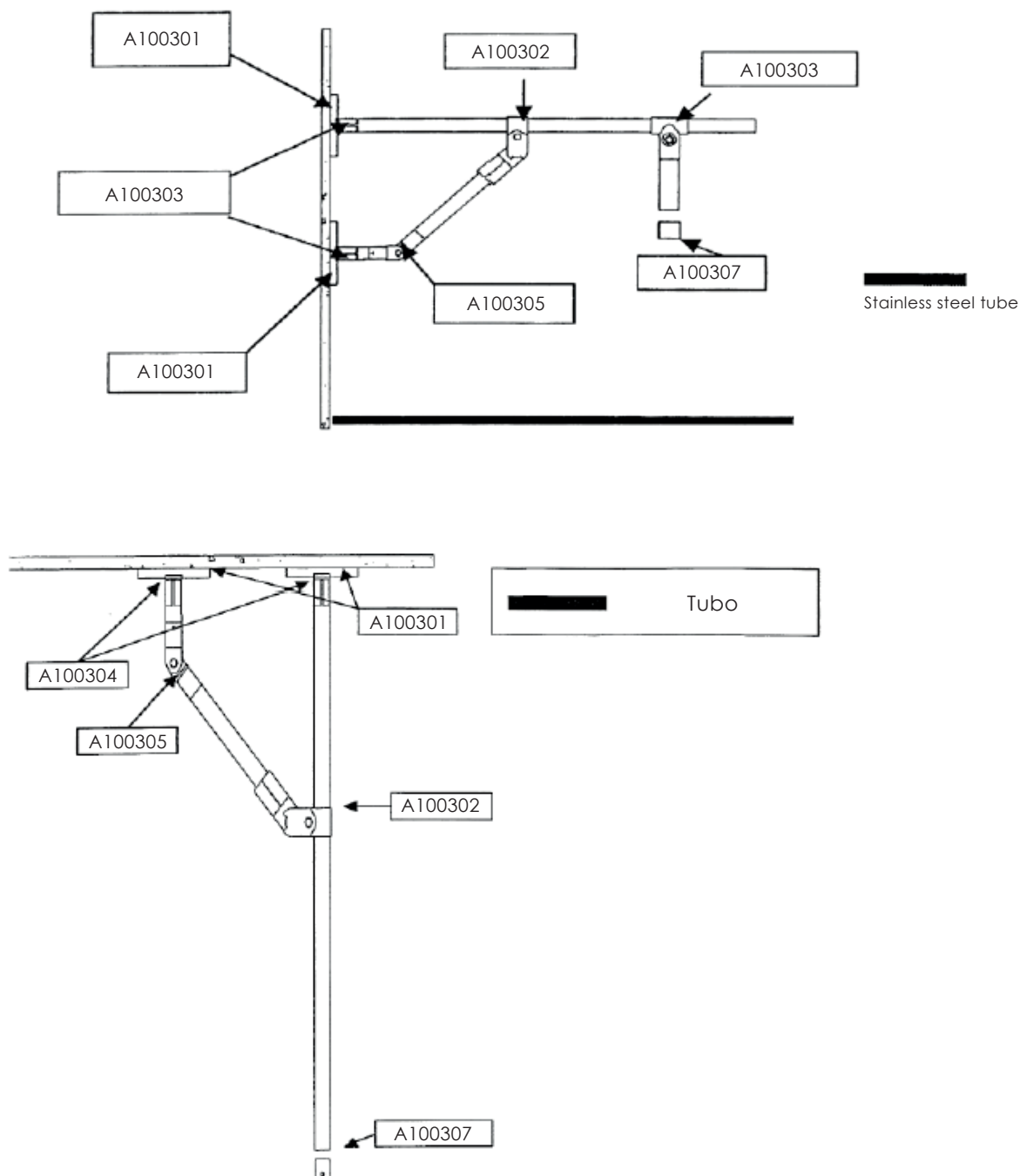



ALEX COLOR

Technical specifications:

- 7" colour display
- Washable touchless high-speed or mechanical keyboard
- 8 dots/mm thermal printer with "easy loading" feature
- Linerless adhesive paper option
- Print speed 70 mm/s
- Paper width 57 mm
- Programmable receipt header (5 lines of 26 characters)
- Automatic date and time management
- Single or cumulative receipt
- Printing of packing date and expiry date
- Print ingredient list associated with the PLU (12 lines of 45 micro characters)
- Batch insertion and printing
- EAN13 barcode printing
- 999 programmable PLUs
- Change function
- Quick change of prices
- Re-opening receipt function
- Reverse entry function
- Semi-automatic, manual, pre-stored and associated tare
- Partial total of 8 operators on screen
- Up to 6 scales in LAN network (wired or RF)
- Scale programming from PC
- General, PLU and operator totals
- Optional radio frequency kit
- 4-8-16 operators
- Optional 12/24V external power supply
- Internal rechargeable battery
- Customer-side graphic images
- Available capacities: 30kg/5g; 12-30kg/2-5g; 12kg/2g; 6kg/1g

Model	Code
ALEX COLOR BIANCA with capacitive keyboard	NSUC030-CN8WHITE
ALEX COLOR NERA with capacitive keyboard	NSUC030-CN8BLACK
ALEX COLOR ARGENTO with capacitive keyboard	NSUC030-CN8SILVER
ALEX COLOR BIANCA with mechanical keyboard	NSUC030-MN8WHITE
ALEX COLOR NERA with mechanical keyboard	NSUC030-MN8BLACK
ALEX COLOR ARGENTO with mechanical keyboard	NSUC030-MN8SILVER

Accessories and options	Code
Basin plate	OSU0PTB
Networking cable	ACVTEL-4X0.12
Factory-fitted 12/24V output	ASE9001.0.AMBUL
Factory-fitted radio frequency kit	OSU0RFQ
Stainless steel foot each	APV10449IM10X25
Top quality adhesive paper printer kit factory fitted	AASKEDP
Thermal neutral roll 57x30 each	CRCT-57B
Adhesive linerless 55.5x18 each	CRAZ-57X50X18
Confbil configuration software	WCONF-ECO
Scale cover	ACOPRIBILANCIA
Ethernet card	ASE5076-ETH





LONG-LIFE
LITHIUM BATTERY



FOR MARKETS
AND STREET
VENDORS



ALEX COLOR EXTRA

Technical specifications:

- 7" colour display
- Washable touchless high-speed or mechanical keyboard
- 8 dots/mm thermal printer with "easy loading" feature
- Linerless adhesive paper option
- Print speed 70 mm/s
- Paper width 57 mm
- Programmable receipt header (5 lines of 26 characters)
- Automatic date and time management
- Single or cumulative receipt
- Printing of packing date and expiry date
- Batch insertion and printing
- EAN13 barcode printing
- 999 programmable PLUs
- Change function
- Quick change of prices
- Print ingredient list associated with the PLU (12 lines of 45 micro characters)
- Re-opening receipt function
- Reverse entry function
- Semi-automatic, manual, pre-stored and associated tare
- Partial total of 8 operators on screen
- Up to 6 scales in LAN network (wired or RF)
- Scale programming from PC
- General, PLU and operator totals
- Optional radio frequency kit
- 4-8-16 operators
- Optional 12/24V external power supply
- Internal lithium battery with power supply and autonomy of about 35/40 hours
- Customer-side graphic images
- Available capacities: 30kg/5g; 12-30kg/2-5g; 12kg/2g; 6kg/1g

Model	Code
ALEX COLOR EXTRA BIANCA with capacitive keyboard	NSUX030-CN8WHITE
ALEX COLOR EXTRA NERA with capacitive keyboard	NSUX030-CN8BLACK
ALEX COLOR EXTRA ARGENTO with capacitive keyboard	NSUX030-CN8SILVER
ALEX COLOR EXTRA BIANCA with mechanical keyboard	NSUX030-MN8WHITE
ALEX COLOR EXTRA NERA with mechanical keyboard	NSUX030-MN8BLACK
ALEX COLOR EXTRA ARGENTO with mechanical keyboard	NSUX030-MN8SILVER

Accessories and options	Code
Basin plate	OSU0PTB
Networking cable	ACVTEL-4X0.12
Factory-fitted 12/24V output	ASE9001.0.AMBUL
Factory-fitted radio frequency kit	OSU0RFQ
Stainless steel foot each	APV10449IM10X25
Top quality adhesive paper printer kit factory fitted	AASKEDP
Thermal neutral roll 57x30 each	CRCT-57B
Adhesive linerless 55.5x18 each	CRAZ-57X50X18
Confbil configuration software	WCONF-ECO
Scale cover	ACOPRIBILANCIA
Ethernet card	ASE5076-ETH

ALEX COLOR

Technical specifications:

- 7" colour display
- Washable touchless high-speed or mechanical keyboard
- 8 dots/mm thermal printer with "easy loading" feature
- Linerless adhesive paper option
- Print speed 70 mm/s
- Paper width 57 mm
- Programmable receipt header (5 lines of 26 characters)
- Automatic date and time management
- Single or cumulative receipt
- Printing of packing date and expiry date
- Print ingredient list associated with the PLU (12 lines of 45 micro characters)
- Batch insertion and printing
- EAN13 barcode printing
- 999 programmable PLUs
- Change function
- Quick change of prices
- Re-opening receipt function
- Reverse entry function
- Semi-automatic, manual, pre-stored and associated tare
- Partial total of 8 operators on screen
- Up to 6 scales in LAN network (wired or RF)
- Scale programming from PC
- General, PLU and operator totals
- Optional radio frequency kit
- 4-8-16 operators
- Optional 12/24V external power supply
- Internal rechargeable battery
- Customer-side graphic images
- Available capacities: 30kg/5g; 12-30kg/2-5g; 12kg/2g; 6kg/1g



Carbon



Wood

Model	Code
ALEX COLOR CARBONIO with capacitive keyboard	NSUC030-CN8CARBON
ALEX COLOR LEGNO with capacitive keyboard	NSUC030-CN8WOOD
ALEX COLOR CARBONIO with mechanical keyboard	NSUC030-MN8CARBON
ALEX COLOR LEGNO with mechanical keyboard	NSUC030-MN8WOOD

Accessories and options	Code
Basin plate	OSU0PTB
Networking cable	ACVTEL-4X0.12
Factory-fitted 12/24V output	ASE9001.0.AMBUL
Factory-fitted radio frequency kit	OSU0RFQ
Stainless steel foot each	APV104491M10X25
Top quality adhesive paper printer kit factory fitted	AASKEDP
Thermal neutral roll 57x30 each	CRCT-57B
Adhesive linerless 55.5x18 each	CRAZ-57X50X18
Long-life lithium battery kit with power supply	OSU0LITIO
Confbil configuration software	WCONF-ECO
Scale cover	ACOPRIBILANCIA
Ethernet card	ASE5076-ETH

ALEX COLOR BASSA



Technical specifications:

- 7" colour display
- Washable touchless high-speed or mechanical keyboard
- 8 dots/mm thermal printer with "easy loading" feature
- Linerless adhesive paper option
- Print speed 70 mm/s
- Paper width 57 mm
- Programmable receipt header (5 lines of 26 characters)
- Automatic date and time management
- Single or cumulative receipt
- Printing of packing date and expiry date
- Print ingredient list associated with the PLU (12 lines of 45 micro characters)
- Batch insertion and printing
- EAN13 barcode printing
- 999 programmable PLUs
- Change function
- Quick change of prices
- Re-opening receipt function
- Reverse entry function
- Semi-automatic, manual, pre-stored and associated tare
- Partial total of 8 operators on screen
- Up to 6 scales in LAN network (wired or RF)
- Scale programming from PC
- General, PLU and operator totals
- Optional radio frequency kit
- 4-8-16 operators
- Optional 12/24V external power supply
- Internal rechargeable battery
- Customer-side graphic images
- Available capacities: 30kg/5g; 12-30kg/2-5g; 12kg/2g; 6kg/1g

Model	Code
ALEX COLOR BASSA NERA with capacitive keyboard	NSUBC30-CBLACK
ALEX COLOR BASSA ARGENTO with capacitive keyboard	NSUBC30-CGLIT
ALEX COLOR BASSA BIANCA with capacitive keyboard	NSUBC30-CWHITE
ALEX COLOR BASSA NERA with mechanical keyboard	NSUBC30-MBLACK
ALEX COLOR BASSA ARGENTO with mechanical keyboard	NSUBC30-MGLIT
ALEX COLOR BASSA BIANCA with mechanical keyboard	NSUBC30-MWHITE

Accessories and options	Code
Basin plate	OSU0PTB
Networking cable	ACVTEL-4X0.12
Factory-fitted 12/24V output	ASE9001.0.AMBUL
Factory-fitted radio frequency kit	OSU0RFQ
Stainless steel foot each	APV10449IM10X25
Top quality adhesive paper printer kit factory fitted	AASKEDP
Adhesive linerless 55.5x18 each	CRCT-57B
Linerless adesivo 55.5x18 cad	CRAZ-57X50X18
Confbil configuration software	WCONF-ECO
Ethernet card	ASE5076-ETH



LONG-LIFE
LITHIUM BATTERY



FOR MARKETS
AND STREET
VENDORS

ALEX COLOR EXTRA BASSA

Technical specifications:

- 7" colour display
- Washable touchless high-speed or mechanical keyboard
- 8 dots/mm thermal printer with "easy loading" feature
- Linerless adhesive paper option
- Print speed 70 mm/s
- Paper width 57 mm
- Programmable receipt header (5 lines of 26 characters)
- Automatic date and time management
- Single or cumulative receipt
- Printing of packing date and expiry date
- Print ingredient list associated with the PLU (12 lines of 45 micro characters)
- Batch insertion and printing
- EAN13 barcode printing
- 999 programmable PLUs
- Change function
- Quick change of prices
- Re-opening receipt function
- Reverse entry function
- Semi-automatic, manual, pre-stored and associated tare
- Partial total of 8 operators on screen
- Up to 6 scales in LAN network (wired or RF)
- Scale programming from PC
- General, PLU and operator totals
- Optional radio frequency kit
- 4-8-16 operators
- Optional 12/24V external power supply
- Internal lithium battery with power supply and autonomy of about 35/40 hours
- Customer-side graphic images



Model

Model	Code
ALEX COLOR BASSA NERA with capacitive keyboard	NSUBX30-CBLACK
ALEX COLOR BASSA ARGENTO with capacitive keyboard	NSUBX30-CGLIT
ALEX COLOR BASSA BIANCA with capacitive keyboard	NSUBX30-CWHITE
ALEX COLOR BASSA NERA with mechanical keyboard	NSUBX30-MBLACK
ALEX COLOR BASSA ARGENTO with mechanical keyboard	NSUBX30-MGLIT
ALEX COLOR BASSA BIANCA with mechanical keyboard	NSUBX30-MWHITE

Accessories and options

Accessories and options	Code
Basin plate	OSU0PTB
Networking cable	ACVTEL-4X0.12
Factory-fitted 12/24V output	ASE9001.0.AMBUL
Factory-fitted radio frequency kit	OSU0RFQ
Stainless steel foot each	APV10449IM10X25
Top quality adhesive paper printer kit factory fitted	AASKEDP
Thermal neutral roll 57x30 each	CRCT-57B
Adhesive linerless 55.5x18 each	CRAZ-57X50X18
Confbil configuration software	WCONF-ECO
Ethernet card	ASE5076-ETH



RETAIL



ALEX

Technical specifications:

- ABS frame in white, blue or red colour
- Custom backlit LCD display
- Mechanical keyboard with rubber keys
- 8 dots/mm thermal printer with "easy loading" feature
- Linerless adhesive paper option
- Print speed 70 mm/s
- Paper width 57 mm
- Programmable receipt header (5 lines of 26 characters)
- Automatic date and time management
- Single or cumulative receipt
- Printing of packing date and expiry date
- Print ingredient list associated with the PLU (12 lines of 45 micro characters)
- Batch insertion and printing
- EAN13 barcode printing
- 999 programmable PLUs
- Change function
- Quick change of prices
- Re-opening receipt function
- Reverse entry function
- Semi-automatic, manual, pre-stored and associated tare
- Partial total of 4 operators on screen
- Up to 6 scales in LAN network (wired or RF)
- Scale programming from PC
- General, PLU and operator totals
- Optional radio frequency kit
- 4-8-16 operators
- Optional 12/24V external power supply
- Internal battery autonomy of about 35/40 hours
- Customer-side graphic images
- Available capacities: 30kg/5g; 12-30kg/2-5g; 12kg/2g; 6kg/1g

Model	Code
Alex blu kg 12/30:2/5g	NSUA030-N8BLU
Alex rossa kg 12/30:2/5g	NSUA030-N8RED
Alex bianca kg 12/30:2/5g	NSUA030-N8

Accessories and options	Code
Basin plate	OSU0PTB
Networking cable	ACVTEL-4X0.12
Factory-fitted 12/24V output	ASE9001.0.AMBUL
Factory-fitted radio frequency kit	OSU0RFQ
Stainless steel foot each	APV10449IM10X25
Top quality adhesive paper printer kit factory fitted	AASKEDP
Transparent key cover	ACOPRITASTI
Thermal neutral roll 57x30 each	CRCT-57B
Adhesive linerless 55.5x18 each	CRAZ-57X50X18
Confbil configuration software	WCONF-ECO
Scale cover	ACOPRIBILANCIA
Ethernet card	ASE5076-ETH





ALEX with labeller ZD421T



Technical specifications:

- Storage of PLUs and ingredients in the scale
- EAN13 barcode and expiry date storage in the scale, associated with the PLU
- Label format associated to PLU
- 12 ingredient lines of 45 characters each that can be associated to the PLU (total 100 lists)
- Manual batch insertion
- Input of number of labels to be printed (for body printing)
- Possibility of manually printing a total label with weight total, amount total and number of labelled packages
- 999 programmable PLUs
- Optional 12/24V external power supply
- Internal battery autonomy of about 35/40 hours
- Available capacities: 30kg/5g; 12-30kg/2-5g; 12kg/2g; 6kg/1g
- L label formats stored in the labeller
- PLU information and ingredients stored in the scale

Model	Code
Alex blu kg 12/30 : 2/5 g with labeller ZD421T	NSUA030-N8BLU + E910
Alex rossa kg 12/30 : 2/5 g with labeller ZD421T	NSUA030-N8RED + E910
Alex bianca kg 12/30 : 2/5 g with labeller ZD421T	NSUA030-N8 + E910

Accessories and options	Code
Basin plate	OSU0PTB
Networking cable	ACVTEL-4X0.12
Factory fitted 12/24V output	ASE9001.0.AMBUL
Factory-fitted radio frequency kit	OSU0RFQ
Stainless steel foot each	APV10449IM10X25
Top quality adhesive paper printer kit factory fitted	AASKEDP
Transparent key cap	ACOPRITASTI
Confbil configuration software	WCONF-ECO
Scale cover	ACOPRIBILANCIA
Ethernet card	ASE5076-ETH

ALEX BASSA



Technical specifications:

- ABS frame in white, blue or red colour
- Mechanical keyboard with rubber keys
- 8 dots/mm thermal printer with "easy loading" feature
- Linerless adhesive paper option
- Print speed 70 mm/s
- Paper width 57 mm
- Programmable receipt header (5 lines of 26 characters)
- Automatic date and time management
- Single or cumulative receipt
- Printing of packing date and expiry date
- Print ingredient list associated with the PLU (6 lines of 45 micro characters)
- Batch insertion and printing
- EAN13 barcode printing
- 999 programmable PLUs
- Change function
- Quick change of prices
- Re-opening receipt function
- Reverse entry function
- Semi-automatic, manual, pre-stored and associated tare
- Partial total of 4 operators on screen
- Up to 6 scales in LAN network (wired or RF)
- Scale programming from PC
- General, PLU and operator totals
- Optional radio frequency kit
- 4-8-16 operators
- Optional 12/24V external power supply
- Internal battery autonomy of about 35/40 hours
- Customer-side graphic images
- Available capacities: 30kg/5g; 12-30kg/2-5g; 12kg/2g; 6kg/1g

Model	Code
Alex bassa blu kg 12/30 : 2/5 g	NSUBA30-N8BLU
Alex bassa rossa kg 12/30 : 2/5 g	NSUBA30-N8RED
Alex bassa bianca kg 12/30 : 2/5 g	NSUBA30-N8WHITE

Accessories and options	Code
Basin plate	OSU0PTB
Networking cable	ACVTEL-4X0.12
Factory-fitted 12/24V output	ASE9001.0.AMBUL
Factory-fitted radio frequency kit	OSU0RFQ
Stainless steel foot each	APV10449IM10X25
Top quality adhesive paper printer kit factory fitted	AASKEDP
Transparent key cover	ACOPRITASTI
Thermal neutral roll 57x30 each	CRCT-57B
Adhesive linerless 55.5x18 each	CRAZ-57X50X18
Confbil configuration software	WCONF-ECO
Ethernet card	ASE5076-ETH



ALEX MARE

Technical specifications:

- Internal date-clock management
- Programmable receipt header (5 lines of 26 characters)
- 100 PLUs
- Graphic thermal printer 8dots/mm (speed: 70 mm/s, paper width: 57mm)
- EAN13 programmable barcode printing
- Change function
- Reopening receipt
- Reverse entry function
- Quick PLU price change
- Manual, automatic or PLU-associated tare
- 2 operators
- Sub-total display of operators
- Custom backlit LCD display
- Evening total of operators and PLUs
- 6V 12Ah battery power supply for long life (approx. 35/40 hours with battery saving active)
- Available capacities: 6/15kg-2/5g 15/30kg-5/10g

Model

Alex Mare capacity 15/30kg-5/10g multirange

Alex Mare capacity 6/15kg-2/5g multirange

Code

NSUA030-MARE

NSUA015-MARE

Accessories and options

Basin plate

Thermal neutral roll 57x30 each

Scale cover

Code

OSU0PTB

CRCT-57B

ACOPRIBILANCIA

ALEX MARE BASSA

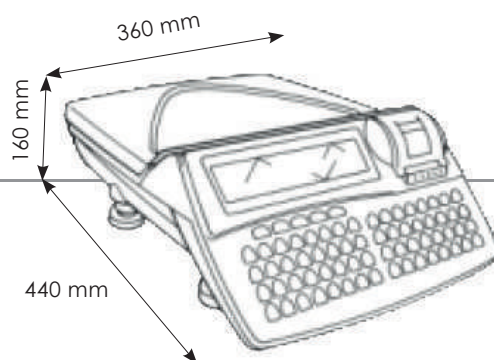

Technical specifications:

- Internal date-clock management
- Programmable receipt header (5 lines of 26 characters)
- 100 PLUs
- Graphic thermal printer 8dots/mm (speed: 70 mm/s, paper width: 57mm)
- EAN13 programmable barcode printing
- Change function
- Reopening receipt
- Reverse entry function
- Quick PLU price change
- Manual, automatic or PLU-associated tare
- 2 operators
- Sub-total display of operators
- Custom backlit LCD display
- Evening total of operators and PLUs
- 6V 12Ah battery power supply for long life (approx. 35/40 hours with battery saving active)
- Available capacities: 6/15kg-2/5g 15/30kg-5/10g

Model

Alex Mare Bassa capacity 15/30kg-5/10g multirange

Alex Mare Bassa capacity 6/15kg-2/5g multirange

Code

NSUBA30-N8MARE

NSUBA15-N8MARE

Accessories and options

Basin plate

Thermal neutral roll 57x30 each

Code

OSUOPTB

CRCT-57B



RETAIL

STELLA



Bars, ice cream parlours, confectioners' shops, hawkers, restaurants and trattorias will find their ideal scale in Eurobil Stella.

It is a very practical scale that fits well in any type of space and furnishing.

The scale focuses on reliability: the load cell system, the simple and water-resistant keyboard, new and safe.

It is available with mains and internal battery power as standard. Two types of pan (bowl and flat) to suit every need.

With Eurobil Stella your work will become easier and your sales operations will be even faster.

Technical specifications:

- Weight sensor: load cell with autozero device
- Capacities and divisions: 6/15 kg div. 2/5 g
- Weight: 4.5 kg
- Power supply: 220 VAC +10% -15% 50/60 Hz
- Dimensions: (W x H x D) 300 x 120 x 330 mm
- Keyboard: 25-key waterproof membrane
- Displays: 3 front-side and 3 rear-side liquid crystal displays (lcd) backlit
- Flat rectangular plate: (W x D) 300 x 240 mm
- Rectangular bowl plate: (W x H x D) 310x230x35
- Tare operation
- Rechargeable internal battery 4 AH / 6V autonomy of 150 hours
- Working temperature: -10°C + 40°C
- 9 direct PLUs
- CE-M approval and metrological booklet

Model	Code
Stella Bassa capacity 6/15 kg-2/5 g multirange	BSTELLA015
Stella Bassa capacity 15/30 kg-5/10g multirange	BSTELLA030
Stella with column capacity 6/15 kg-2/5 g multirange	BSTELLA015-C
Stella with column capacity 15/30 kg-5/10 g multirange	BSTELLA030-C
Accessories and options	Code
Basin plate	API-2521S1

MINI STELLA



Bars, ice cream parlours, confectioners' shops, hawkers, restaurants and trattorias will find their ideal scale in Eurobil Mini Stella.

It is in fact a very practical scale that fits well in any type of space and furnishing.

The scale focuses on reliability: the load cell system, the simple and water-resistant keyboard, new and safe.

It is available with mains and internal battery power as standard. Two types of pan (bowl and flat) to suit every need.

With Eurobil Mini Stella your work will become easier and your sales operations will be even faster.



Technical specifications:

- Weight sensor: load cell with autozero device
- Capacities and divisions: 3/6 kg div. 1/2 g
- Weight: 4.5 kg
- Power supply: 220 VAC +10% -15% 50 Hz
- Dimensions: (W x H x D) 225 x 110 x 300 mm
- Keyboard: 20-key waterproof membrane
- Displays: 3 front-side and 3 rear-side liquid crystal displays (lcd) backlit
- Flat rectangular plate: (W x D) 250 x 225 mm
- Tare operation
- Rechargeable internal battery 4 AH / 6V autonomy of 150 hours
- Working temperature: -10°C + 40°C
- 9 direct PLUs - 90 indirect PLUs
- CE-M approval and metrological booklet

Model

Mini Stella capacity 3/6 kg-1/2 g multirange

Code

BSTELLA003

Accessories and options

Basin plate

Code

API-2521S1



PC-TOUCH labelling stations



LABELLING SYSTEM COMBINED WITH PC-TOUCH
ALUMINIUM BODY IDEAL FOR INDUSTRIAL ENVIRONMENTS

Mode of use:

- Graphical interface for article selection and labels on aluminium chassis touch PC
- Possibility of connection to our instruments Iscale - Fly Plus - SunEco - SunEco Alex
- Available versions, complete station consisting of: PM42 labeller with aluminium chassis touch PC, stainless steel trolley, FLY PLUS viewer and stainless steel platform
- Unlimited number of articles
- Job management via PC-touch: add, delete, article selection, convenient management of variable label fields editable directly from label editing program
- Programmable EAN13, EAN128, QR CODE barcodes

Software:

- Unlimited number of label formats customisable via included graphic label editing programme

Print speed:

- A 203 dpi/300 dpi: 100 mm/s–300 mm/s
- A 406 dpi: 100 mm/s–250 mm/s

Complete labelling station with aluminium chassis PC-TOUCH, stainless steel trolley, FLY PLUS screen and stainless steel platform in the following available versions:

Model	Capacity (Max Kg)	Division (g)		Code
M30X30 with labeller PD45S	12/30	2/5		EPC-TOUCHM3012
M40X40 with labeller PD45S	12/30	2/5		EPC-TOUCHM4012
M60X60 with labeller PD45S	30/60	10/20		EPC-TOUCHM6030
M60X60 with labeller PD45S	60/150	20/50		EPC-TOUCHM6060
Model	Capacity (Max Kg)	Division (g)		Code
M30X30 with labeller ZD421T	12/30	2/5		EPC-TOUCHM3012-Z
M40X40 with labeller ZD421T	12/30	2/5		EPC-TOUCHM4012-Z
M60X60 with labeller ZD421T	30/60	10/20		EPC-TOUCHM6030-Z
M60X60 with labeller ZD421T	60/150	20/50		EPC-TOUCHM6060-Z

** Certified system for tax credit 4.0

Pc Touch Screen



Technical specifications:

- Cabinet format, integrated system with 15" LCD panel, made of extruded aluminium
- TFT LCD panel, 15" TFT LCD panel, 1024x768 with capacitive touch screen
- AC97 compatible audio
- Motherboard embedded speakers: integrated 3W stereo speakers
- Motherboard format W 204 x D 145 mm, LAN standard Realtek 8100BL Ethernet 10/100 embedded on board
- Microprocessor:
 - CPU:** Intel® Bay-Trail J1900 Quad Core
 - RAM:** DDR3L, 1333/1600 MHz, 1*SO- DIMM (4G as standard, optional up to 8 GB)
 - 3 RS232 DB9** pin serial ports
 - 1 Lan** RJ45 ethernet port
 - 1 VGA** port (x secondary display)
 - 4 USB** ports
- Standard 64 GB SSD hard disk
- Operating temperature 0°C ~ 35°C
- Operating system Windows 10

Model

PC touch Screen 15"

Code

PC-TOUCH



RETAIL

SOFTWARE DI ETICHETTATURA

LabelOne

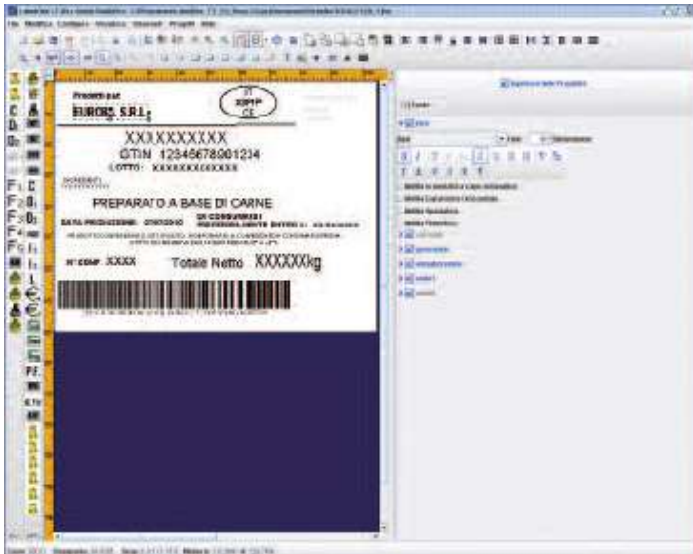

Graphic Software for Label Design



Working software

Technical specifications:

- Dual platform management
- Automatic, manual or programmed tare subtraction
- Weighing totalization on three levels (box, pallet, pallet total)
- Management and printing of selected customer header
- Programming of article archive with:
 - code, 2 alphanumeric descriptions, 2500 characters in the ingredient field, expiry date, days of staging, tare, price, EAN13 barcode, EAN128 code, automatic totalisers, traceability lists, nutrition tables
- Possibility of multiple expiry dates for the same article
- Quick and easy batch field editing
- Storing article history
- Storing customer history
- No limit on the number of articles, customers, traceability lists and label formats
- Possibility of exporting and importing data from external management software

Model	Code
Labelling software LabelOne	WLSL4.0
Batch management labelling software, shipping document, invoice	WPPS

TROLLEYS

Stainless steel **double-deck trolley**



Trolley with stainless steel
shelves with pull-out drawer



Floor scale 30x30 with Fly Plus

FLY PLUS, fiscal memory version, to be connected to PC TOUCH with column and 30x30 stainless steel platform Multirange 12/30 kg division 2/5g



Model	Code
Stainless steel double-deck trolley	OM61C2P
Trolley with stainless steel shelves with pull-out drawer	OM41CAS
Floor scale 30x30 with Fly Plus	BM308030-FLYPLU

Label printers



PD455 Technical specifications:

- Dimensions: 484x292x283 mm
- Thermal or thermal transfer printing
- Maximum width at 203 dpi: 108 mm (4.25 ips)
- Print speed: 203 dpi/300 dpi: 100 mm/s-300 (4 ips-12 ips)
- Print resolution:
 - 203 dpi: 8 dots/mm
 - 300 dpi: 11.8 dots/mm
 - 406 dpi: 16 dots/mm
- Peeler and rewinder

Interfaces:

- Ethernet 10/100 Mbps
- RS-232, fino a 115,2 KB/s
- USB 2.0
- USB Host X



2D421T Technical specifications:

- Print width 4.09" / 104 mm
- Max. printing speed:
 - 152 mm (6") per second (203 dpi)
 - 102 mm (4") per second (300 dpi)
- Communication methods:
 - usb v2.0 (Standard)
 - Serial rs-232 (optional)
 - Ethernet 10/100 (optional)
 - Wireless: 802.11ac with bluetooth 4.1 (factory installed option)
- Print resolution
 - 203 dpi/8 dots per mm
 - 300 dpi/12 dots per mm (optional)
- Media sensors
 - Multi-position transmissive sensor and full-width reflectant

Model

Printer Labeller PD45S with rewinder

Printer-Labeller ZD421T

Code

EPD45

E910

Barcode Readers



Single-line laser scanner

Based on technology from the Voyager series, Honeywell's Data-Logic single-line laser scanner offers outstanding ease of use and excellent reading capabilities for linear barcodes up to 58 centimetres long.

Optimised for fast scanning of linear barcodes, even in the case of damaged or poorly printed codes, the Data-Logic's combination of excellent scanning performance and extended depth of field makes it an ergonomic solution ideal for applications requiring a high number of scans.

- **Extended depth of field:**

Enables easy scanning of objects at a distance and allows users to read 13 mil barcodes up to a distance of 447 mm.

- **Ergonomic design:**

Suitable for all hand types, reduces user fatigue in applications requiring a high number of scans.

- **Ease of use:**

Quick and easy stand assembly facilitates installation; ergonomic design reduces user fatigue in applications requiring a high number of scans.

- **High processing speed:**

Ensures effective object detection and automatic In-Stand detection and setup; extended depth of field makes it easier to scan objects from a distance.



Wireless area-imaging reader

- **Bluetooth wireless technology:**

makes it easy to scan all standard 1D, PDF and 2D barcodes up to 10 metres from the base (depending on the environment).

- **Superior 1D code performance:** unlike conventional laser readers, the 1D version of the Data-Logic QBT can read barcodes omnidirectionally, making it ideal for presentation mode scanning.

- **Support for future needs:**

for those who only need 1D scanning but may be interested in 2D scanning in the future, the Data-Logic QBT can be easily upgraded from 1D to 2D scanning at any time.

- **Mobile reading:**

scans coupons and tickets from the displays of mobile devices.

- **Long-lasting, on-site removable battery:**

the on-site replaceable lithium-ion battery provides over 14 hours of battery life depending on the scan volume.

Model	Code
Voyager 1250 G	SCANNER-V1250
Voyager 1452 G	SCANNER-V1452

WEIGHING AND PRICING MACHINE



Technical specifications:

depending on version

- Application area
 - Pack sizes
From mm (40x40x3) to mm (600x400x300)
Applications with larger pack sizes will be checked by our Technical Service Department
 - Label dimensions
From mm (20x20) to mm (110x100)
 - Operating speed
Approx. up to 200 pcs/min.
 - Max. capacity 1.5 - 3 - 6 - 12 - 30 Kg Division
1 - 2 - 5 g
 - 3" or 4" print head
200 dpi resolution, Air Jet high speed applicator, compensated pneumatic cylinder, arm
 - Viewer
15" colour Touch Panel
 - Software for easy creation of label layout and product management from panel.

- Power supply
 - Electric
 - Voltage 230 Vac $\pm 5\%$ single-phase 50/60Hz Power max 250 VA Current max 1.0 A Industrial socket compliant with IEC 309-2
 - Pneumatic (only with gun or cylinder application)
 - Compressed air at 6 bar pressure (10 mm inlet pipe) Compressed air must be filtered and dehumidified
- Dimensions
Length 700 - 2400 mm Width 800 mm Height Max. 1600 mm
- Connections
Ethernet, USB, VPN (remote assistance)
- Materials
AISI 304 and stainless materials
- Certification
Machines complying with 2014/32/EU - MID All 6 Classes Y(a) – XIII(1)

Model	Code
One-belt weight-pricing machine	TCE9500
Three-belt weight-pricing machine	TCE9500M

GTW-INOX

STAINLESS STEEL WEIGHING



**Main
features:**

- Stainless steel IP68 degree of protection
- Battery autonomy 70 hours
- 220 VAC power supply
- Pan size mm. 230x210
- CE-M certification and metrology certificate

Model	Code
Electronic scale GTW kg. 1,5/3 : 0,5/1g INOX	BGTW01.5
Electronic scale GTW kg. 3/6 : 1/2g INOX	BGTW003
Electronic scale GTW kg. 6/15 : 2/5g INOX	BGTW006
Electronic scale GTW kg. 15/30 : 5/10g INOX	BGTW015



COMETA SCALE



Electronic “weight only” bench scale, with piece-counting, autozero and tare function, can operate either on mains or battery power with relative low battery signal.

Technical specifications:

- Equipped with backlit LCD display with 30mm high digits for easy reading.
- Stainless steel weighing plate.
- Externally calibrated instrument.
- CE-M approval and metrology booklet.

Model

Cometa capacity 6/15 kg - 2/5 g multirange

Cometa capacity 15/30 kg - 5/10 g multirange

Code

BCOMETA015

BCOMETA030

Accessories and options

Basin plate

Code

API-2521S1

ACS-Z SCALE



Technical specifications:

- Battery charger inside, you can use the scale while charging the battery
- Auto-zero tracking
- Possibility to set auto-zero when switching on the scale
- Various switches including: weigh-count-percentum
- Various weight ranges to choose from.
- Dimensions: 235x335mm (optional 210x270mm)
- 230 V - /100 V-, 50/60 Hz

Model

ACS-Z capacity 30kg division 1g

Code

BACS-Z-030



RETAIL

MERCURY 24 PACKAGE SCALE MADE IN ITALY



Main features MERCURY 24 platforms

- Stainless steel red LED display
- Additional on-screen status indicators
- Accuracy class III, 3000 divisions
- Uses OIML R60-approved aluminium single point load cell with dust and moisture protection to IP65 standards (350 Ohm input resistance).
- Power supply: internal long-life battery (6 VDC/4Ah) and mains power (220 VAC - 50/60 Hz)
- Weighted summation function
- Piece-counting function
- Tare and zero reset function
- 60 cm column (h standard)
- Stainless steel pan 40x40 cm or 60x60 cm
- Oven-baked tubular structure.
- Levelling feet and level bubble.

Pan available versions mm	Height mm	Load capacities and DIV		Code
		Max kg*	CE-M g	
400x400	125	60	10/20 g	PMERCURY403060
400x400	130	150	20/50 g	PMERCURY403150
600x600	150	150	20/50 g	PMERCURY603060
600x600	150	300	50/100 g	PMERCURY603000

Model accessories		Code
Cart M40 painted		OM40CAR
Cart M40 stainless steel		OM41CAR
Cart M60 painted		OM60CAR
Cart M60 stainless steel		OM61CAR

CALYBRA



Features:

- Restricted access via PIN
- Language settable for each user
- User management and permitted functions
- Adding and editing new INGREDIENTS and RECIPES
- Automatic calculation of ice cream balance parameters
- Sequential weighing of recipes
- Intuitive weighing interface
- Consultation of production history
- Production traceability

Technical specifications:

- Maximum load capacity: 30kg
- Division: 1 g
- Plate size: 30x30 cm
- Dimensions: 30x40x72 cm
- Power supply: 100 - 240 V ~ 50 - 60 HZ
- Connections: 2 x USB - 1 LAN - 1 RS232 - 1 POWER INPUT 19V
- Display: 10.4" - 800x600
- Touch: Resistive - Frame: 18/10 stainless steel
- Aluminium column or vesa bracket

Model	Code
CALYBRA with column	NKAL030-C
CALYBRA VESA	NKAL030-V
Accessories and options	Code
Wall bracket	OKAL-KSV01
Bracket with joint	OKAL-KSV02



CALYBRA BAKERY



Features:

Station for:

- Weighing of incoming raw materials (Purchase shipping document)

- Distribution (Delivery shipping document) of finished product by weight: fresh bread, pastry and deli products

Distribution:

- Weighing of finished product by weight: fresh bread, products bakery and delicatessen products.

- Operator is guided by customer or product type to the exact weighing and delivery of the order.

- Returns weighing

- Creation in the Calybra Box management system of delivery routes for each customer and/or your shop

- Allocation of a recurring order for each day of the week

- Management of holidays and/or company closures

- Automatic creation of a production order to be sent to Calybra stations for product manufacture

- Fulfillment of orders generated by Calybra Tower workstations

- Real-time issue of shipping documents for each destination (customers and/or points of sale)

Technical specifications:

- Stainless steel platform
- Dimensions 600x600mm
- Load capacity 60kg division 5g
- Stainless steel trolley

DISPLAY

- 27" TFT LCD backlit panel with LED technology
- Contrast / Brightness 300 cd/sqm
- Maximum Resolution 1080 x 1920
- Contrast ratio 3000 (typ.)

TOUCH SCREEN - Type Projective Capacitive Touch

EXTERNAL I/O PORTS

- USB 6x USB 2.0
- LAN 1x Gigabit Ethernet, RJ-45

POWER SUPPLY

- External Power Supply 24V, 6A
- 3-pin connector

PEDESTAL

- Material Painted metal with galvanised steel base
- Rear safety door

PHYSICAL FEATURES

- Operating temperature 0° ~ 60°C at 10% ~ 90% humidity
- Storage temperature -20° ~ 80°C at 10% ~ 90% humidity
- Colour Glossy white
- Dimensions (W x H x D) and net weight
- Centre unit / 42.6x88x13.5 cm
- Pedestal unit / 42.6x90x13.5 cm
- Base plate / 60x1x41 cm
- Total net weight / 36 kg
- CE-certified

Model

SISTEMA CALYBRA BAKERY

Code

EKA-BAKERY

General Information

The products mentioned in this price list comply with the European standards for electromagnetic compatibility (EMC) and, where applicable, electrical safety. They are CE marked instruments and can therefore be freely sold in all countries of the European Community or other countries.

Since they are mostly measuring instruments, they may be subject to internal regulations in each country.

Unless otherwise specified, the instruments are duly CE-certified with regard to the European regulations for non-automatic weighing instruments (NAWI) in class III.

In the case of all instruments which are required to meet special performance requirements not covered by the certification, or

which do not have metrological certification, Eurobil accepts no liability for any fraudulent use of the instrument in question by the user.

Eurobil will then subject the weighing instruments to metrological verification in accordance with the accuracy class of the instrument in question, which is then marked with plates bearing the symbols required by the EC approval certificates. They are then protected against tampering by seals of the appointed Notified Body.

The relevant declarations of conformity are then issued, which must accompany the instrument at the place of installation.

General Terms and Conditions of Sale

1) PREMISE:

The conditions of sale indicated below, will be applied to all customer orders, received and accepted by Eurobil, having as their object the sale of products, machines, consumables or other objects of Eurobil resale. The sales prices, expressed in euros, will be those stated in the price list (which are net of VAT). Special supplies will be quoted from time to time and communicated by means of a duly dated and numbered written offer.

2) VALIDITY OF THE PRICE LIST:

This price list shall remain in force until a new version is issued. Eurobil reserves the right to change it at any time without giving any prior notice, but to notify all encoded customers in writing at a later date. In this case, Eurobil will allow a short period of time (approx. 20-30 days), in which to conclude any quotations that the customer still has open negotiations.

3) ORDERS:

The customer's order must be submitted to Eurobil in writing (fax or other). Only in exceptional cases will a telephone order be considered. The order, if possible on the letterhead of the writing company and duly signed by the customer. Orders will only be considered accepted after the order confirmation has been issued by Eurobil. This will be sent to the customer, who must return it duly countersigned and reconfirmed in all parts. In the event that this does not occur, the order shall be deemed automatically accepted.

4) DELIVERIES:

The delivery dates will be those stated on the order confirmation. It is Eurobil's right to inform the customer when the goods are ready but, even if this is usually the case, we invite the parties concerned to check that this delivery date has been respected by telephoning before collecting the goods.

5) SHIPPING COSTS:

All deliveries shall be made to the consignee and, in any case, ex Eurobil, except for those agreed otherwise by mutual agreement. Where possible, Eurobil may arrange shipment via its own contracted carrier and charge the freight costs to the invoice.

6) SHIPPING RISKS:

In all cases of transport, including carriage free of charge charged on the invoice, Eurobil is exempt from any liability for theft, loss, damage or other. Only in the event that Eurobil carries out the delivery with its own personnel, Eurobil shall be liable from the Eurobil head office to the place of delivery.

7) TESTING AND INSTALLATION COSTS:

The costs of testing and installation are generally excluded and, if required, will be assessed in the final invoice.

8) WARRANTY:

Eurobil guarantees that, at the time of delivery, its products are free from defects in materials and workmanship, however, a warranty period of twelve months from the date of delivery shall apply. Excluded will be any parts which have been tampered with due to misuse by the operator, the carrier or technicians not authorised by Eurobil. Transport costs accompanying the goods to be repaired shall be borne by the customer both in the case of delivery and in the case of collection of the repaired product. Any claims for errors or defects in the products must be made in writing within eight days of receipt of the goods. Eurobil will repair or replace (if it considers it necessary) the products or their parts, excluding any other responsibility for direct damage to persons or things belonging to the customer, resulting from the use or non-use of the same. Parts replaced with new or reconditioned parts shall become the property of Eurobil.

9) PACKAGING COSTS:

Packaging, where applicable, shall be charged at cost

10) RESERVATION OF OWNERSHIP:

Goods which are delivered to the customer against his order shall be deemed to be the property of Eurobil until payment of the total agreed price and the relevant duties and taxes. The programmes granted for use to the customer remain, in any case, the exclusive property of Eurobil and/or third parties of which Eurobil is a licensee. In the event of non-payment within the terms stipulated in the order, Eurobil may terminate the order without prejudice to any of its other rights and regain possession of the goods, demanding compensation for all damages deriving from, connected with and related to this, which will be borne by the defaulting customer.

11) PAYMENTS:

Standard payments will be as follows:

- first deliveries absolutely payment by bank transfer in advance with an additional discount of 3% (valid only for prompt payment)
 - invoices of less than € 250,00 payment by bank receipt with a 30-day due date invoice end of month - regardless of the usual terms of payment
- Special terms of payment shall be taken into account and customised, depending on the customer's annual turnover and, in any case, mutually agreed upon by both parties. Exceptions or disputes shall not entitle the customer to suspend payments.

12) CUSTOMER SERVICE:

A telephone assistance service and/or on-site intervention by Eurobil's specialised technical staff is available (in this case a request must be made to the Sales Department). In this case, labour hours (at € 55.00 per hour), any spare parts and travel and travel expenses will be charged (please note that travel hours will be charged at € 70.00 per hour and € 0,65 per km travelled).

13) JURISDICTION:

For any dispute, the Court of BUSTO ARSIZIO shall have exclusive jurisdiction



**For 30 years we have been
developing flexible and cost-effective
solutions for your point of sale**



E.M.L. Inspection Body Via Olona, 183/D - 21013 Gallarate(VA) - ITALY - eml@eurobil.it

WE GIVE WEIGHT TO YOUR WORK

Warranty, reliability and production **made in Italy**



Via Olona, 183/C 21013 Gallarate (VA) Italy
Tel. +39 0331 793449
commerciale@eurobil.it

